

Summer student placement

We recently interviewed several Museum Studies MA students from the University of Leicester for a summer placement which completes their course. We are delighted to announce that Kashu Bian has been appointed. Kashu, who has previously studied in Hong Kong and China, has a background in journalism and will join us for 8 weeks from mid-July to September. Kashu will help us organise our archive material, and with the aim of mounting an exhibition of some of the more interesting material for the early autumn.

Patience still required!

It remains the case that that is not possible for HLF to make any announcements at present about the projects they considered in March – and the General Election announcement complicates matters further. We are therefore still not in a position to make any further comment ourselves, until at least after local government elections on 4 May.

Pete Hobson – 20th April 2017
Project Director
pete.hobson@leccofe.org

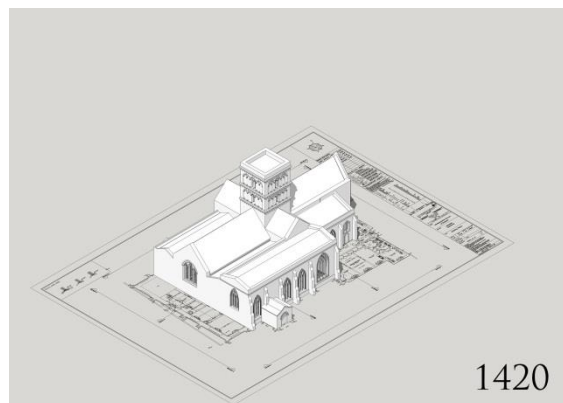

Late Medieval (Henry V) - the chancel is enlarged and St Dunstan's chapel added