

So what on earth are you doing at the moment?

The early stages of the Development period are under way, and (to the wider public) not terribly interesting! We are spending quite a bit of time meeting the HLF requirements for procurement – that is to engage the specialist disciplines we need to help us on the way. These include structural engineers, mechanical and electrical engineers, quantity surveyors and consultants on acoustics, AV, fire, passivhaus, legal advice. Then there's the specialists on Interpretation and Activity planning, the need for a Conservation Plan – not to mention the creation of a Project Business Plan, which meshes well with the Cathedral's overall Strategic Planning. If it's exhausting reading all of that, imagine how it is delivering it. But we'll get these – mostly by the end of the summer holidays! And then we can begin developing our proposals from the early form they are now into something capable of being submitted for formal planning approval.

Meanwhile the other week Elisa Simmons (our deputy administrator) and I spent two days on a national conference for cathedral buildings people, based around Ely and Bury St Edmund's Cathedrals. These are two very different buildings from each other, and from us. But it was good to meet people plying the same trade, in different locations.

Pete Hobson – 26th July 2017

Project Director

pete.hobson@leccofe.org

0116 261 5363

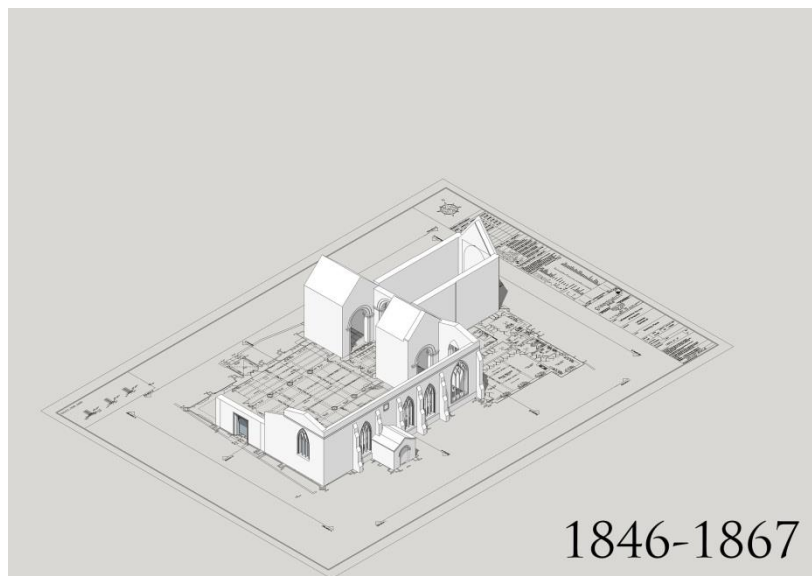

The extent of the work overseen by Victorian architect Raphael Brandon